

# STAGE 6

1535 m<sup>2</sup> / 16522.6 sq ft

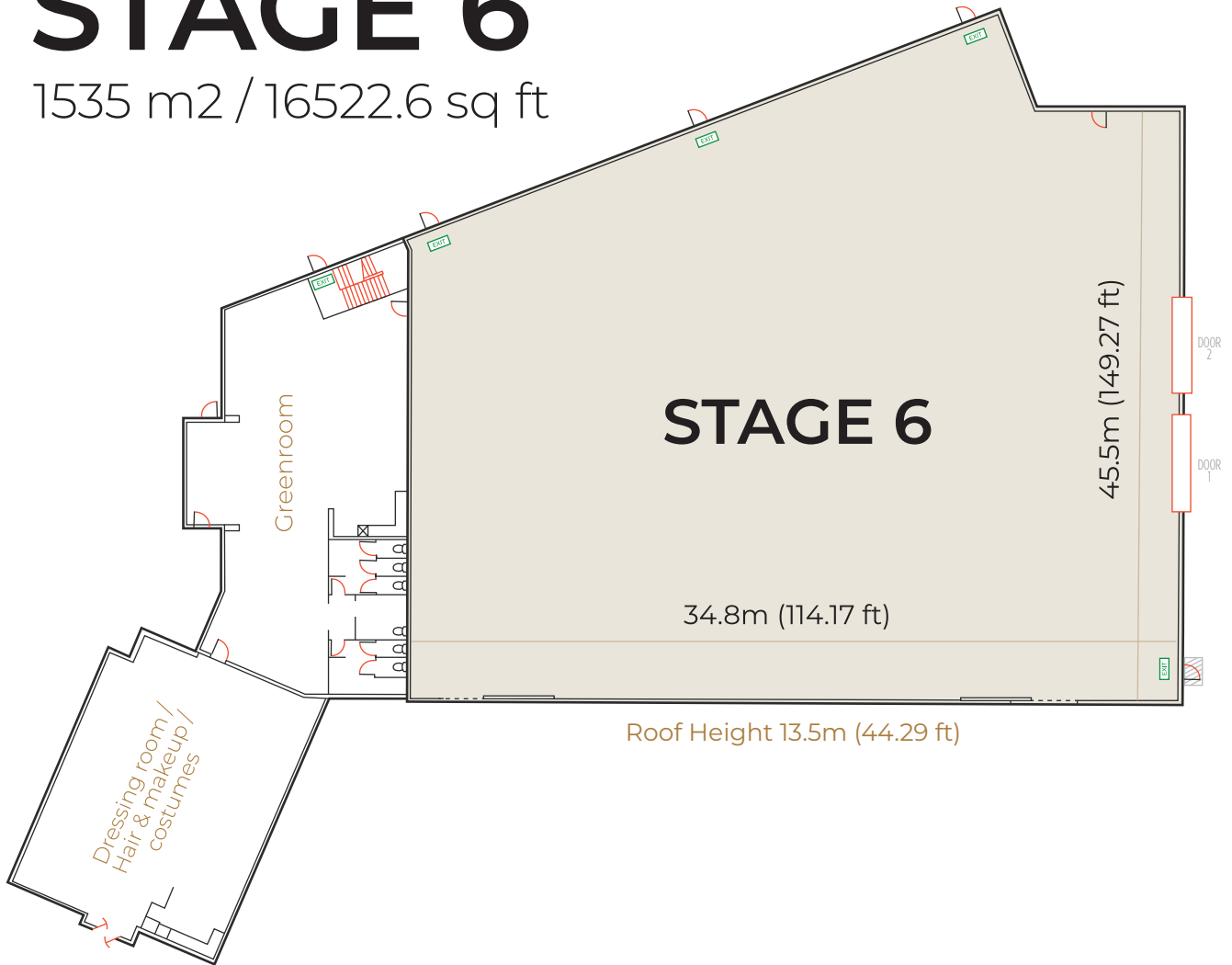

## Specifications

<b>Dimensions</b>	34.8m (114.17 ft) x 45.5m (149.27 ft)
<b>Roof Height</b>	15.9m (52.16 ft) - 13.5m (44.29 ft) clear to the truss
<b>Floor</b>	1535 m <sup>2</sup> / 16522.6 sq ft
<b>Greenroom</b>	213.5 m <sup>2</sup> / 2298.0 sq ft
<b>H&amp;MUP / Dressing / Costumes</b>	190.05 m <sup>2</sup> / 2045.6 sq ft
<b>Kitchenette &amp; Restrooms</b>	YES
<b>Door 1 (WxH)</b>	5.5m (18.0 ft) x 5m (16.4 ft)
<b>Door 2 (WxH)</b>	5.5m (18.0 ft) x 5m (16.4 ft)
<b>Power</b>	650amp 3-Phase
<b>Air-Conditioned</b>	YES
<b>Soundproofed</b>	YES